



MCCUBBIN 2 STOREY
FRONT CARPORT (3 BED)





Overall Dimensions
6.5 x 15.3m (199m²)

UPPER LEVEL

- | | |
|-------------------------|---|
| 1. Living – 5.8 x 3.8m | 7. Ensuite – 2.4 x 2.6m |
| 2. Dining – 5.7 x 2.5m | 8. WC – 2.2 x 1.5m |
| 3. Kitchen – 5.1 x 4.0m | 9. Balcony under roof (optional) – 2.4 x 6.5m |
| 4. Pantry – 1.6 x 1.3m | 10. Balcony (optional) – 2.1 x 6.5m |
| 5. Bed 1 – 4.3 x 3.9m | 11. Balcony (optional) – 1.5 x 7.0m |
| 6. WIR – 1.8 x 2.2m | |

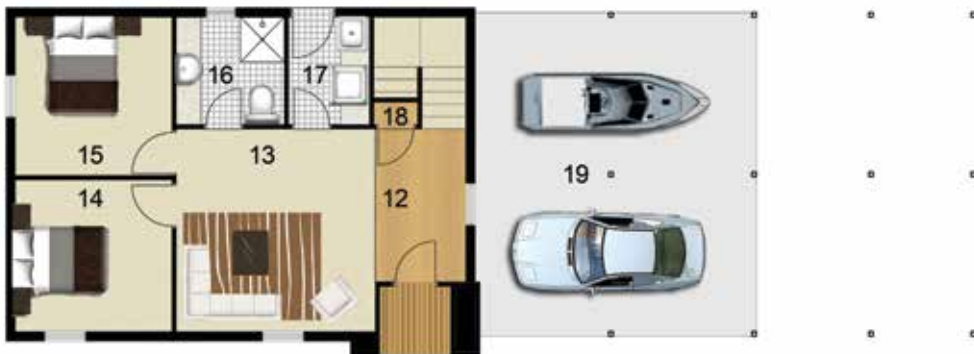

LOWER LEVEL

- | |
|--------------------------|
| 12. Entry – 1.9 x 3.1m |
| 13. Family – 4.1 x 4.1m |
| 14. Bed 3 – 3.1 x 3.2m |
| 15. Bed 2 – 3.2 x 3.2m |
| 16. Bath – 2.2 x 2.2m |
| 17. Laundry – 2.2 x 1.7m |
| 18. Linen |
| 19. Carport – 6.5 x 5.8m |