



McCubbin

2 STOREY FRONT CARPORT



McCubbin

2 STOREY FRONT CARPORT
6.5 x 15.3m (199m²)

Upper Level

- 1. Living - 5.8 x 6.5m
- 2. Dining - 4 x 2.7m
- 3. Kitchen - 2.6 x 4m
- 4. Pantry - 1.6 x 1.3m
- 5. Bed 1 - 4.3 x 2.9m
- 6. WIR - 1.8 x 2.2m
- 7. Ensuite - 2.4 x 2.6m
- 8. WC - 2.2 x 1.5m
- 9. Balcony under Roof 2.4 x 6.5m
- 10. Deck (optional) 2.1 x 6.5m
- 11. Deck (optional) 1.5 x 7.0m



Upper Level

Lower Level

- 12. Entry - 1.9 x 3.1m
- 13. Family - 4.1 x 4.1m
- 14. Bed 3 - 3.1 x 3.2m
- 15. Bed 2 - 3.2 x 3.2m
- 16. Bath - 2.2 x 2.2m
- 17. Laundry - 2.2 x 1.7m
- 18. Linen
- 19. Carport - 6.5 x 5.8m

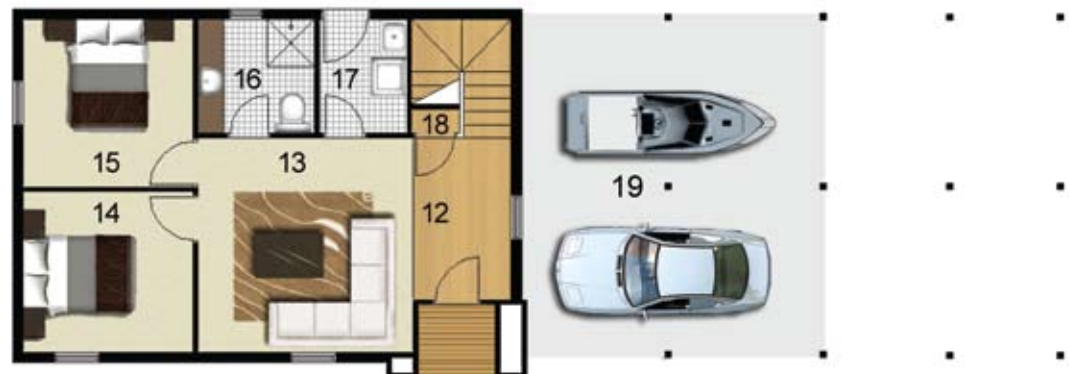

Lower Level